

# Globebus A Class

The most compact motorhome range from Dethleffs drives as easily and dynamically as a van! Ideal for city trips and mountain roads. But despite all its compactness, it knows how to convince with the advantages of a full-grown motorhome such as insulation, freedom of movement and kitchen and bathroom equipment. For those who value striking sporty details, the Gran Turismo equipment package is just right.

## Upholstery



+ Floyd upholstery



+ Duke upholstery \*

## Wood décor



+ Rosario Cherry wood décor

\*optionally available

## Technical info\*

Technically permissible total mass	3499 / 3650 kg
Overall length, approx.	599 - 695 cm
Overall width, approx.	220 cm
<b>Overall height, approx.</b>	<b>281 cm</b>

\* Maximum values partly not possible for all models or only in connection with certain options.

## Plus factors

- + Proven Dethleffs quality at an attractive price
- + Sporty, striking Gran Turismo (GT) equipment package (optional)
- + Agile and safe handling due to compact exterior dimensions with an external width of only 2.20 m
- + Fully equipped kitchen with 2-burner hob and Multiflex rail system
- + Pleasant sleeping comfort thanks to 7-zone cold foam mattresses made of climate-regulating material and ergonomic wooden slatted frames



# Globebus A Class

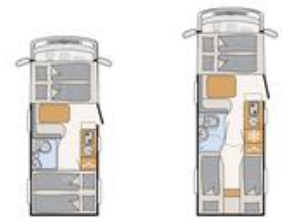

Globebus A Class		I 1	I 6
Standard chassis		Fiat Ducato Light low platform	Fiat Ducato Light low platform
Emission standards		Euro 6d Final	Euro 6d Final
Overall length, approx.	cm	599	695
Overall width, approx.	cm	220	220
Overall height, approx.	cm	281	281
Headroom in living area, approx.	cm	198	198
Insulation floor / side walls / roof	mm	49 / 34 / 35	49 / 34 / 35
Towable load braked/unbraked	kg	2000 (750)	2000 (750)
Tire size		225/75R 16C	225/75R 16C
Wheelbase, approx. mm	mm	3450	3800
Bed dimension: Front bed, L x W, approx.	cm	185 x 150	185 x 150
Bed dimension: Rear bed, L x W, approx.	cm	200 x 145	200 x 155 ○ / 195 x 80 / 195 x 75
Sleeping berths		4	4
Standard engine		120 Multijet 3	120 Multijet 3
kW (hp)		88 (120)	88 (120)
Unladen weight, approx.	kg	2550	2710
Mass in running order, approx.	kg	2730	2890
Maximum load, approx.	kg	769 / 920 ○	609 / 760 ○
Technically permissible total mass	kg	3499 / 3650 ○	3499 / 3650 ○
Permitted number of persons		4	4
Heating		Hot Air, 6 kW Gas / Hot air with E-bar, 7.8 kW Gas-Electric ○	Hot Air, 6 kW Gas / Hot air with E-bar, 7.8 kW Gas-Electric ○
Refrigerator volume incl. freezer, approx.	l	83 (8) / 142 (15) ○	142 (15)
Waste water tank, approx.	l	90	90
Water supply incl. boiler (reduced volume) ca.	l	114 (20)	114 (20)
Measurement storage opening left	cm	95 x 80	95 x 105
Measurement storage opening right	cm	75 x 100	95 x 105
Sockets: 12 V / 230 V / USB		1 / 6 / 2	1 / 6 / 2

# Standard equipment

11

16

Fiat chassis		
15-inch steel wheels incl. full wheel trims	⊙	⊙
Fiat Ducato Light low platform chassis (3.499 kg maximum authorised weight)	⊙	⊙
Fiat Ducato Multijet 120 (2.2 l / 120 HP)	⊙	⊙
Fiat chassis features		
6-gear manual transmission	⊙	⊙
ABS (anti-lock braking system) / EBD (electronic brakeforce distribution)	⊙	⊙
Additional protection for radiator through grille at front of vehicle	⊙	⊙
Anti-theft device	⊙	⊙
Captain seats: integrated headrests, two armrests, swivel function	⊙	⊙
Crosswind Assist	⊙	⊙
Cruise control	⊙	⊙
Driver and passenger airbags	⊙	⊙
Driver and passenger detection	⊙	⊙
Driver's cab manual A/C	⊙	⊙
ESP incl. ASR, Traction Plus, Hill Holder and Hill Descent Control	⊙	⊙
Front-wheel drive	⊙	⊙
Low-vibration coach-style exterior mirrors that can be heated and adjusted electrically (two-piece)	⊙	⊙
Rear axle mudflaps	⊙	⊙
Automatic Brake Assist after a collision	⊙	⊙
Cup holder in the centre of the dashboard	⊙	⊙
Diesel tank 75 litre incl. 19L AdBlue tank	⊙	⊙
Fix&Go kit	⊙	⊙
Pleated blinds in the windscreen and side windows of the drive's cab for the best insulation and privacy	⊙	⊙
Trailer Stability Assist	⊙	⊙
Exterior features		
60 cm wide habitation door	⊙	—
70 cm wide habitation door	—	⊙
Bedroom window right and left	⊙	⊙
EPS insulation	⊙	⊙
Flyscreen habitation door	⊙	⊙
GRP roof	⊙	⊙
Panoramic skylight 40x40 cm with flyscreen and blackout blinds above the pull-down bed	⊙	⊙
Rear moulding with third brake light, integral tail lights incl. LED strip	⊙	⊙
Skylight 40 x 40 cm above the lounge	⊙	⊙
Large rear garage: two garage door/hatches with screw cap/tension lock, rear lowering (150 kg surface load) with anti-slip surface, heated, lashing rails, illuminated, 1 x 230 V socket	⊙	⊙
Lifetime construction technology: Tried-and-tested reliable flooring and superstructure with excellent insulation	⊙	⊙
Lounge access via convenient electric step	⊙	⊙
Side panels and rear panel made of resistant high-gloss GRP with smooth, shiny surface	⊙	⊙
Exterior design		
Exterior body painted in white	⊙	⊙
Interior design		
Floyd upholstery	⊙	⊙
Rosario Cherry wood décor	⊙	⊙
Textile equipment		
Fixed beds with ergonomic wooden frame and 150mm thick 7-zone premium mattresses made of heat-regulating material	⊙	⊙
Furniture layouts		
Full-length mirror	⊙	⊙
Overhead locker doors with soft-close function	⊙	⊙
Wardrobe floor-to-ceiling with convenient linen drawers in upper area	⊙	⊙
Cosy L-shaped lounge with free-standing, rigid table base and two integrated 3-point seatbelts	⊙	⊙
Floor-to-ceiling wooden sliding door to the bedroom	—	⊙

# Standard equipment

	I 1	I 6
High-level single beds incl. comfortable access via steps	—	⊙
Manual pull-down bed in the driver's cab	⊙	⊙
Multifunctional storage space underneath the double bed incl. wardrobe, accessible from inside and outside, illuminated, bed frame with adjustable shock absorbers	⊙	—
<b>Kitchen</b>		
Fridge with separate freezer compartment and automatic energy selection (AES) (83 l)	⊙	—
Gourmet kitchen: two-ring hob, large drawers, cutlery tray, bin and generous worktop	⊙	⊙
MultiFlex rail system	⊙	⊙
Floor-to-ceiling fridge with separate freezer compartment and automatic energy selection (AES) (142 l)	—	⊙
<b>Bathroom</b>		
Equipped with cabinets, storage compartments, large mirrors, toothbrush mug and toilet paper holder	⊙	⊙
Swiveling bathroom wall for optimal use of space	⊙	—
<b>Heating</b>		
Hot-air heating 6kW with hot-water boiler	⊙	⊙
<b>Electrical installation</b>		
Awning light 12 V	⊙	⊙
LED lighting throughout the vehicle	⊙	⊙
Leisure battery AGM, 95 Ah	⊙	⊙
On-board control panel	⊙	⊙
Spotlights in the roof lining above the habitation door	⊙	⊙
Starter battery and leisure battery with automatic switch-over (also for fridge)	⊙	⊙
Electric block with integrated overvoltage protection and separate residual-current device	⊙	⊙
<b>Water supply</b>		
Submersible pump	⊙	⊙
Fresh water tank in insulated and heated area	⊙	⊙
<b>Gas supply</b>		
Gas bottle locker for 2 x 11 kg	⊙	⊙

# PACKAGES GLOBEBUS A CLASS

Package	Globebus GT Package White (12159)	Globebus GT Package Grey (12161)
Electric parking brake	X	X
Leather steering wheel and gear knob with leather sleeve	X	X
Dashboard with aluminium application	X	X
Driver's cab automatic A/C	X	X
7" DAB+ moniceiver incl. wireless Apple CarPlay & Android Auto and steering wheel control panel	X	X
70cm wide habitation door with window incl. blackout blinds and central locking system (incl. driver's cab door)	X	X
Luxus on-board control panel	X	X
Driver's cab door left	X	X
DAB+ radio antenna mounted on the roof	X	X
Radio system incl. Sound Package in the driver's cab	X	X
Two-tone sockets and switches	X	X
Stable, double-glazed flush-fitting windows with integrated blinds and flyscreens	X	X
Fiat 16-inch alloy wheels	X	X
Panoramic skylight 75x105 cm in the lounge	X	X
Height and tilt adjustable incl. two padded armrests for the driver and front passenger seat	X	X
Kitchen back panel in metallic grey	X	X
Roof rail	X	X
High-level rear moulding with third brake light, integral tail lights incl. LED strip	X	X
Exterior design GT White (A Class front partially painted black, large GT White sticker, skid plate red)	X	
Exterior design GT Grey (A Class front partially painted black, large GT Grey sticker, skid plate red)		X

Package	Winter Comfort Package hot-air heating (8251)
XPS insulation	X
Insulated under-floor pipes	X
Waste water tank and pipes electrically heated	X
Insulated waste water tank	X
Switch for water pump	X
Hot-air heating 6kW with 1.8kW electric heating element and hot-water boiler incl. digital control panel	X

## Chassis Package (12125)

Electric parking brake  
 7" DAB+ moniceiver incl. wireless Apple CarPlay & Android Auto and steering wheel control panel  
 Dashboard with aluminium application  
 Driver's cab automatic A/C  
 Leather steering wheel and gear knob with leather sleeve

#### **Chassis Package Advance (12119)**

10" DAB+ Naviceiver incl. wireless Apple CarPlay & Android Auto, camper navigation and steering wheel control panel (upgrade to the 7" DAB+ moniceiver)

Digital speedometer with large, digital 7" display

Wireless phone charger in the central console

---

#### **Family Package (12151)**

Radio system incl. Sound Package in the driver's cab

DAB+ radio antenna mounted on the roof

Panoramic skylight 75x105 cm in the lounge

Driver's cab door left

Height and tilt adjustable incl. two padded armrests for the driver and front passenger seat

70cm wide habitation door with window incl. blackout blinds and central locking system (incl. driver's cab door)

Luxus on-board control panel

---

#### **Light Moments Package (11352)**

Indirect ambient lighting above the overhead lockers

Indirect ambient lighting on the walls

---

#### **Pre-wiring kit (11350)**

Pre-wiring for solar

Pre-wiring for roof A/C

Pre-wiring for satellite system

Pre-wiring for first reversing camera

Pre-wiring for second reversing camera

---

# Optional extras

	Included in package	Additional weight	Code	11	16
<b>Fiat chassis</b>					
Fiat Ducato Multijet 180 (2.2 l / 180 HP)	—	0	8554	○	○
Fiat 16-inch alloy wheels	GT	0	8922	○	○
Fiat Ducato Multijet 140 (2.2 l / 140 HP)	—	0	10775	○	○
Fiat Ducato Multijet 160 (2.2 l / 160 HP)	—	0	10774	○	○
Weight upgrade to 3.650 kg	—	0	10769	○	○
<b>Fiat chassis features</b>					
9-gear torque converter for automatic transmission <sup>1)</sup>	—	18	10736	○	○
Rear corner steadies (2 pieces)	—	6	390	○	○
Reinforced spring for front axle	—	0	1889	○	○
Tow bar (take note of total towing weight)	—	35	273	○	○
<b>Exterior features</b>					
Bike rack for 3 bikes (lowerable)	—	10	7482	○	○
Bike rack for 3 bikes (rear)	—	9	938	○	○
Double floor in rear garage	—	5	1890	○	○
Omnistor cassette awning 4.0 m (manual)	—	33	859	○	—
Omnistor cassette awning 5.0 m (manual)	—	54	697	—	○
Panoramic skylight 70x50 cm above the pull-down bed	—	8	246	○	○
Stable, double-glazed flush-fitting windows with integrated blinds and flyscreens	GT	5	415	○	○
<b>Interior design</b>					
Duke upholstery	—	0	11949	○	○
<b>Textile equipment</b>					
Loose carpets	—	8	851	○	○
<b>Furniture layouts</b>					
Option to convert single beds to double bed	—	9	1883	—	○
Isofix child seat bracket for third and fourth seat facing direction of travel	—	5	8125	○	○
<b>Kitchen</b>					
Fridge (142 l) instead of tall wardrobe	—	15	713	○	—
<b>Bathroom</b>					
Additional window in bathroom	—	5	372	○	○
Shower grid	—	1.5	1657	○	●
<b>Multimedia</b>					
22" flat-screen HD TV (incl. DVD player, HDMI, DVB-S2 satellite receiver and DVB-T2 terrestrial receiver) <sup>2) 3)</sup>	—	3	11506	○	○
Automatic HD satellite system 65 Twin <sup>4)</sup>	—	10	11258	○	○
Flat-screen TV bracket	—	3	325	○	○
Reversing camera (double camera)	—	2	1641	○	○
Reversing camera (single camera)	—	2	1642	○	○
Second reversing camera in rear moulding	—	1	11541	○	○
Top view 360° camera	—	6	7173	○	○
<b>Heating</b>					
Digital control element for hot-air heating	—	1	6622	○	○
Floor heating electric (partial) <sup>6)</sup>	—	9	763	○	○
App operation for hot-air heating <sup>5)</sup>	—	2	9659	○	○
<b>Air Conditioning</b>					
Roof A/C	—	36	11670	○	○
<b>Electrical installation</b>					
Second leisure battery AGM, 95 Ah <sup>7)</sup>	—	27	830	○	○
Solar power system 100 watt	—	15	922	○	○
<b>Water supply</b>					
Insulated waste water tank	WI-KO	3	665	○	○

# Optional extras

	Included in package	Additional weight	Code	11	16
Switch for water pump	WI-KO	1	397	○	○
<b>Gas supply</b>					
Automatic gas bottle switch-over incl. crash sensor and EisEx gas regulator heater	—	3	1577	○	○
Exterior socket for 30mbar gas pressure	—	1	878	○	○
<b>Safety</b>					
2 kg fire extinguisher	—	4	1878	○	○
Alarm system (for door with central locking)	—	5	322	○	○
Safe	—	13	323	○	○
Smoke detector	—	1	1891	○	○
<b>Packages</b>					
Globebus GT Package Grey	—	56.6	12161	○	○
Globebus GT Package White	—	56.6	12159	○	○
Light Moments Package	—	3	11352	○	○
Chassis Package	—	-8.4	12125	○	○
Chassis Package Advance <sup>8)</sup>	—	1.2	12119	○	○
Family Package	—	48	12151	○	○
Pre-wiring kit	—	6.5	11350	○	○
Winter Comfort Package hot-air heating	—	25	8251	○	○
<b>Miscellaneous</b>					
Registration documents	—	0	-	◆	◆
<b>Accessories - Highlights (orderable via Dethleffs Original Accessories)</b>					
Bike carrier	—	0	3236639	—	○
Cab carpet for Globebus I with convection heating	—	0	3226577	○	○
Retrofittable multifunctional rail	—	0	3269437	○	○
Sun protection mat for Globebus I	—	0	2973504	○	○
Thermal window mat for Globebus I	—	0	2973513	○	○
Waste water hose set 2 m	—	0	3220982	○	○
Waste water hose set 4m	—	0	3196483	○	○

○ Optional extra — Not possible ● Standard ◆ Mandatory

GT GT Package WI-KO Winter Comfort Package