

Just Go Low Profile



Experience the world of motorhomes simply and easily - the new Just Go, based on the Ford Transit, does it perfectly.

Comprehensive equipment as well as modern interior with feel-good character, it already has everything on board as standard - and at a real friendship price. Want more? The Comfort Package supplements the standard equipment with lots of added value: more safety, more comfort, more fun. Just do it!

Technical info

Overall length, approx.	669 - 736 cm
Overall width, approx.	233 cm
Overall height, approx.	299 cm
Headroom in living area, approx.	213 cm

Maximum values partly not possible for all models or only in connection with certain options.

Upholstery



+ Upholstery Ravello



+ Upholstery Calypso
incl. driver and
passenger seat cover
○



+ Upholstery Salerno
incl. driver and front
passenger seat cover

Plus factors

- + Proven Dethleffs quality at an attractive, friendly price
- + 70 cm wide habitation door
- + Interior height 2.13 m (not below pull-down bed)
- + Pleasant sleeping comfort thanks to 7-zone cold foam mattresses made of climate-regulating material and ergonomic wooden slatted frames
- + Optional pull-down bed
- + Fully equipped kitchen with 2-burner hob and Multiflex rail system
- + 137 l fridge with large freezer compartment



Wood décor

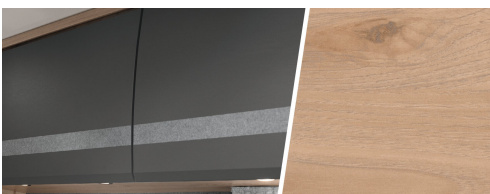

+ Wood décor Noce Nagano

○ optionally available

Just Go Low Profile

Technical info

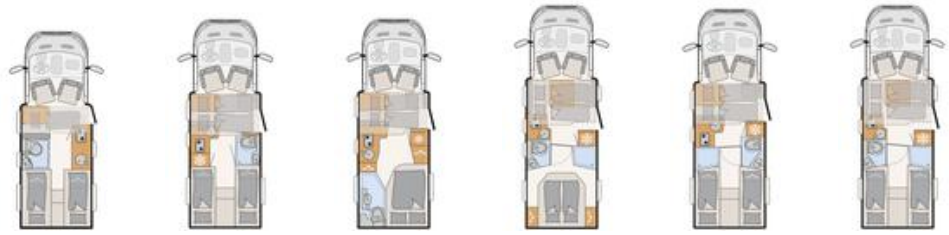

Just Go Low Profile		T 6615 EB	T 6815 EB	T 6905	T 7055 DBL	T 7055 EB	T 7055 EBL
Standard chassis		Ford Transit Low Platform	Ford Transit Low Platform	Ford Transit Low Platform	Ford Transit Low Platform	Ford Transit Low Platform	Ford Transit Low Platform
Emission standards		Euro VI-E	Euro VI-E	Euro VI-E	Euro VI-E	Euro VI-E	Euro VI-E
Overall length, approx.	cm	669	699	699	736	736	736
Overall width, approx.	cm	233	233	233	233	233	233
Overall height, approx.	cm	299 ¹⁾	299 ¹⁾	299 ¹⁾	299 ¹⁾	299 ¹⁾	299 ¹⁾
Headroom in living area, approx.	cm	213	213	213	213	213	213
Towable load braked/unbraked	kg	2000 / 750	2000 / 750	2000 / 750	2000 / 750	2000 / 750	2000 / 750
Wheelbase, approx.	mm	3750	3750	3750	3954	3954	3954
Bed dimension: Front bed, L x W, approx.	cm	200 x 85 ○	200 x 140 - 120 ○	200 x 140 - 120 ○	200 x 140 ○	200 x 140 - 115 ○	200 x 140 ○
Bed dimension: Central / middle bed, L X W, approx.	cm	157 x 101 - 75 ○	210 x 100 - 65 ○	210 x 100 - 65 ○	210 x 105 - 80 ○	210 x 108 - 65 ○	210 x 105 - 80 ○
Bed dimension: Rear bed, L x W, approx.	cm	202 x 80 / 198 x 80 / 210 x 170 ○	198 x 80 / 208 x 80 / 210 x 170 ○	200 x 135 - 100	190 x 150	2x 215 x 80 / 210 x 190 ○	2x 215 x 80 / 210 x 190 ○
Sleeping berths standard / max.		2 / 4 ○	2 / 5 ○	2 / 5 ○	2 / 5 ○	2 / 5 ○	2 / 5 ○
Standard engine		2,0 l TDCi Ford EcoBlue	2,0 l TDCi Ford EcoBlue	2,0 l TDCi Ford EcoBlue	2,0 l TDCi Ford EcoBlue	2,0 l TDCi Ford EcoBlue	2,0 l TDCi Ford EcoBlue
kW (bhp)		96 (130)	96 (130)	96 (130)	96 (130)	96 (130)	96 (130)
Mass in running order (+/-5%)*	kg	2800 (2660 to 2940)*	2865 (2722 to 3008)*	2880 (2736 to 3024)*	2895 (2750 to 3040)*	2885 (2741 to 3029)*	2900 (2755 to 3045)*
Manufacturer-specified mass for optional equipment*	kg	353	290	270	256	266	251
Technically permissible maximum laden mass*	kg	3500	3500	3500	3500	3500	3500
Permitted number of seats (including driver)*		4	4 - 5 ○	4	4	4	4
Refrigerator volume (thereof freezer), approx.		83 (8) / 137 (15) ○	137 (15)	137 (15) / 137 (15) ○	137 (15) / 137 (15) ○	137 (15) / 137 (15) ○	137 (15) / 137 (15) ○



The specified mass in running order is a default value defined in the type-approval procedure. Due to manufacturing tolerances, the actual weighed mass in running order may deviate from the value stated above. Deviations of up to ± 5 % of the mass in running order are legally permissible and possible. The permissible range in kilograms is given in brackets after the mass in running order. The manufacturer-specified mass for optional equipment is a calculated value for each type and layout that Dethleffs uses to determine the maximum weight available for factory-fitted optional equipment. The limitation of optional equipment is intended to ensure that the minimum pay-mass, i.e. the legally prescribed free mass for baggage and retrofitted accessories, is actually available for the vehicle load capacity of the vehicles delivered by Dethleffs. The real weight of your vehicle ex works can only be determined when it is

weighed at the end of the line. If, in exceptional cases, the weighing shows that the actual load capacity falls below the minimum pay-mass despite limiting the optional equipment due to a permissible weight deviation, we will check together with your trade partner and you whether we should, for example, increase the load capacity of the vehicle, reduce the number of seats or remove optional equipment before delivering the vehicle. The technically permissible maximum laden mass of the vehicle and the technically permissible maximum mass on the axle must not be exceeded. Detailed information & explanations on the subject of weight and the configuration of the vehicle can be found in the section Legal information. For a more detailed description of all mandatory technical dependencies, please refer to the explanations on the footnotes.

Just Go Low Profile

Technical info

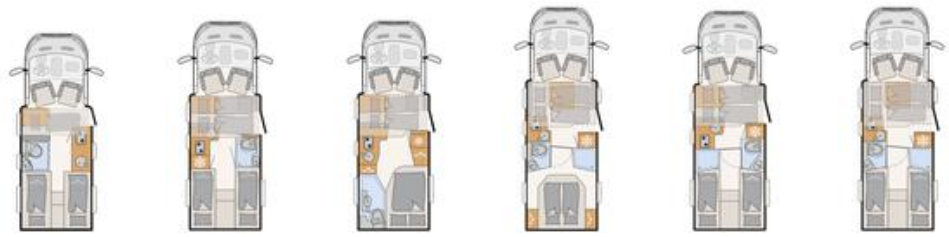

Just Go Low Profile	T 6615 EB	T 6815 EB	T 6905	T 7055 DBL	T 7055 EB	T 7055 EBL
Waste water tank, approx.	95	95	95	95	95	95
Fresh water tank capacity, total/ Fresh water tank capacity at driving filling	115 / 20	115 / 20	115 / 20	115 / 20	115 / 20	115 / 20
Measurement storage opening left (W x H) cm	55 x 95 ○	75 x 95 ○		95 x 95 ○	95 x 95 ○	95 x 95 ○
Measurement storage opening right (W x H) cm	55 x 115	75 x 115	85 x 60	93 x 115	93 x 115	93 x 115

○ Optional equipment — Not possible ● Standard equipment ◆ Mandatory △ Not known at the time of publication



The specified mass in running order is a default value defined in the type-approval procedure. Due to manufacturing tolerances, the actual weighed mass in running order may deviate from the value stated above. Deviations of up to ± 5 % of the mass in running order are legally permissible and possible. The permissible range in kilograms is given in brackets after the mass in running order. The manufacturer-specified mass for optional equipment is a calculated value for each type and layout that Dethleffs uses to determine the maximum weight available for factory-fitted optional equipment. The limitation of optional equipment is intended to ensure that the minimum pay-mass, i.e. the legally prescribed free mass for baggage and retrofitted accessories, is actually available for the vehicle load capacity of the vehicles delivered by Dethleffs. The real weight of your vehicle ex works can only be determined when it is

weighed at the end of the line. If, in exceptional cases, the weighing shows that the actual load capacity falls below the minimum pay-mass despite limiting the optional equipment due to a permissible weight deviation, we will check together with your trade partner and you whether we should, for example, increase the load capacity of the vehicle, reduce the number of seats or remove optional equipment before delivering the vehicle. The technically permissible maximum laden mass of the vehicle and the technically permissible maximum mass on the axle must not be exceeded. Detailed information & explanations on the subject of weight and the configuration of the vehicle can be found in the section Legal information. For a more detailed description of all mandatory technical dependencies, please refer to the explanations on the footnotes.

Standard equipment

	T 6615 EB	T 6815 EB	T 6905	T 7055 DBL	T 7055 EB	T 7055 EBL
Ford chassis						
Ford Transit Light low platform (3,499 kg), TDCi EcoBlue (2.0 l / 96 kW / 130 hp) Heavy Duty, 6-speed manual transmission	●	●	●	●	●	●
Steel rims 16" (236/65 R16) with wheel trims	●	●	●	●	●	●
Ford chassis features						
70l fuel tank	●	●	●	●	●	●
ABS, EBD, ESP, TCS, Hill Start Assist, Crosswind Assist, Safety Brake Assist, Rollover Protection Cab, Emergency Brake Support incl. Emergency Brake Light	●	●	●	●	●	●
Cruise control	●	●	●	●	●	●
Driver airbag	●	●	●	●	●	●
Driver and passenger seat Pilot Chair with double armrest, swivelling	●	●	●	●	●	●
Exterior Colour Cab Frost White	●	●	●	●	●	●
Exterior mirrors manually adjustable	●	●	●	●	●	●
Fix&Go kit (tyre repair kit)	●	●	●	●	●	●
Ford 6-speed manual gear box	●	●	●	●	●	●
Ford audio system radio incl. DAB/DAB+, remote control on steering wheel, hands-free system, 4 speakers and antenna	●	●	●	●	●	●
Front-wheel drive	●	●	●	●	●	●
Leather steering wheel	●	●	●	●	●	●
Passenger airbag	●	●	●	●	●	●
Rear axle mudflaps	●	●	●	●	●	●
Wider rear axle	●	●	●	●	●	●
Exterior features						
70 cm wide habitation door	●	●	●	●	●	●
Bedroom window right and left	●	●	—	●	●	●
Dethleffs Exclusive rear light carrier with 3rd brake light	●	●	●	●	●	●
EPS insulation	●	●	●	●	●	●
Floor thickness: 49 mm, side wall thickness: 34mm and roof thickness: 35 mm	●	●	●	●	●	●
Flyscreen habitation door	●	●	●	●	●	●
GRP roof	●	●	●	●	●	●
Habitation access with comfortable, wide, electric step	●	●	●	●	●	●
Large rear garage: right-hand garage door with turn/tighten lock, rear lowering (150 kg surface load), anti-slip surface, heated, lashing strips, illuminated, 1x 230 V socket	●	●	—	●	●	●
Lifetime construction technology: Tried-and-tested reliable flooring and superstructure with excellent insulation	●	●	●	●	●	●
Side panels and rear panel made of resistant high-gloss GRP with smooth, shiny surface	●	●	●	●	●	●
Skylight 40 x 40 cm above the seating lounge	●	●	●	●	●	●
Exterior design						
Exterior body painted in white	●	●	●	●	●	●
Interior design						
Upholstery Ravello	●	●	●	●	●	●
Wood décor Noce Nagano	●	●	●	●	●	●
Textile equipment						
Fixed beds with ergonomic wooden slatted frames and 150 mm thick 7-zone premium mattresses made of climate-regulating material	●	●	●	●	●	●
Furniture layouts						
Cosy lounge seating group with free-standing, rigid table base	—	—	—	●	—	●
French double bed	—	—	●	—	—	—
Height-adjustable double bed	—	—	—	●	—	—
High-level single beds incl. comfortable access via steps	●	●	—	—	●	●
Overhead locker doors with soft-close function	●	●	●	●	●	●
Room-height wardrobes with clothes rail or shelves	—	—	●	—	—	—
Seating area with mountable and extendible table and two integrated 3-point seatbelts	●	●	●	—	●	—
Wardrobe to the left and right of the queen-size bed	—	—	—	●	—	—
Kitchen						
Floor-to-ceiling fridge with separate freezer compartment and automatic energy selection (AES) (137 l)	—	●	●	●	●	●

Standard equipment

	T 6615 EB	T 6815 EB	T 6905	T 7055 DBL	T 7055 EB	T 7055 EBL
Fridge with separate freezer compartment and automatic energy selection (AES) (83 l)	●	—	—	—	—	—
Gourmet kitchen: two-ring hob, large drawers, cutlery tray, bin and generous worktop	●	●	●	●	●	●
MultiFlex rail system incl. hooks (further accessories via Dethleffs Original Accessories)	●	●	●	●	●	●
Bathroom						
Equipped with cabinets, storage compartments, large mirrors, toothbrush mug and toilet paper holder	●	●	—	●	●	●
Large bathroom with separate shower and toilet with locking door to the lounge	—	—	—	●	●	●
Swiveling bathroom wall for optimal use of space	●	●	●	—	—	—
Heating						
Gas hot-air heating 6kW with hot-water boiler	●	●	●	●	●	●
Heating in the seating unit for optimum heat distribution, built-in	●	●	●	●	●	●
Electrical installation						
Automatic switch-on/disconnect for starter battery, leisure battery and refrigerator	●	●	●	●	●	●
Awning light 12 V	●	●	●	●	●	●
Dimmable LED lighting in the separate shower and toilet room	—	—	—	●	●	●
Electric block with integrated overvoltage protection and separate ground fault circuit breaker	●	●	●	●	●	●
LED lighting throughout the vehicle	●	●	●	●	●	●
Leisure battery AGM, 95 Ah	●	●	●	●	●	●
Number of sockets 1x 12V, 7x 230V, 4x USB	●	—	—	—	—	—
Number of sockets 1x 12V, 8x 230V, 4x USB	—	●	●	●	●	●
On-board control panel	●	●	●	●	●	●
Spotlights in the roof lining above the habitation door	●	●	●	●	●	●
Water supply						
Fresh water tank in insulated and heated area	●	●	●	●	●	●
Submersible pump	●	●	●	●	●	●
Gas supply						
Storage space for 2 gas bottles with a filling weight of 11 kg each	●	●	●	●	●	●

PACKAGES JUST GO LOW PROFILE

Package	Package One, 4 m awning (12126)	Package One, 4,5 m awning (12126)	Package X (awning 4.0 m) (11936)	Package X (awning 4.5 m) (11936)
Automatic HD satellite system 65 Twin	x	x		
Flat screen 22" HD TV (incl. DVD player, HDMI, DVB-S2 satellite receiver and terrestrial DVB-T2 receiver)	x	x		
Flat-screen TV bracket	x	x		
Rear view camera (single camera)	x	x	x	x
Omnistor cassette awning 4.0 m (manual)	x		x	
Omnistor cassette awning 4.5 m (manual)		x		x
Additional weight (kg)*	51.6	55.6	35.1	39.1



* INFO

The factory installation of optional equipment increases the actual mass of the vehicle and reduces the pay-mass. The additional weight indicated for packages and optional equipment shows the additional weight compared to the standard equipment of the respective model or layout. The total weight of the selected optional equipment must not exceed the manufacturer-specified mass for

optional equipment shown in the model overviews. This is a calculated value for each type and layout that Dethleffs uses to determine the maximum weight available for factory-fitted optional equipment. Detailed information and explanations on the subject of weight can be found in the Legal information section.

Package	Comfort Package T 6615 EB (13803)	Comfort Package T 6815, 7055 EB (13803)	Comfort Package T 7055 DBL (13803)	Comfort Package T 7055 EBL (13803)	Comfort Package T 6905 (13803)	Camper Premium Package (13715)
Air conditioning incl. dust and pollen filter	x	x	x	x	x	x
Glove compartment with lid, lockable	x	x	x	x	x	x
Interior package Trend Line	x	x	x	x	x	x
Side protection strips painted in car colour	x	x	x	x	x	x
Front bumper painted in car colour	x	x	x	x	x	x
Fog light	x	x	x	x	x	x
Headlamps with static cornering light	x	x	x	x	x	x
Electrically adjustable and heated exterior mirrors	x	x	x	x	x	x
Alloy wheel Ford 16" , black	x	x	x	x	x	
Windscreen, heatable	x	x	x	x	x	
Windscreen wiper with rain sensor	x	x	x	x	x	
Emergency brake assist, activ (camera-based)	x	x	x	x	x	
Lane Assist with drowsiness warning, High Beam Assist and Lane Keep Assist	x	x	x	x	x	
Headlight assist with day/night sensor	x	x	x	x	x	
Habitation door with window incl. blackout and central locking (incl. cab door)	x	x	x	x	x	
Panorama skylight 70 x 50 cm in the living area	x	x	x	x	x	
Upholstery Salerno incl. driver and front passenger seat cover	x	x	x	x	x	
Indirect ambient lighting on the walls	x	x	x	x	x	
Indirect ambient lighting above the overhead lockers	x	x	x	x	x	
Cab blackout blinds	x	x	x	x	x	
Opening window in T-hood	x	x	x	x	x	
Cosy L-shaped seating group with free-standing, lowerable table base and 2 integrated 3-point belts	x	x			x	
Option to convert single beds to double bed	x	x		x		
Access locker door left	x				x	
Access locker door left		x	x	x		
Additional weight (kg)*	51.65	53.65	37.65	45.65	43.65	13



The factory installation of optional equipment increases the actual mass of the vehicle and reduces the pay-mass. The additional weight indicated for packages and optional equipment shows the additional weight compared to the standard equipment of the respective model or layout. The total weight of the selected optional equipment must not exceed the manufacturer-specified mass for

optional equipment shown in the model overviews. This is a calculated value for each type and layout that Dethleffs uses to determine the maximum weight available for factory-fitted optional equipment. Detailed information and explanations on the subject of weight can be found in the Legal information section.

Package	Winter Comfort Package hot-air heating Just Go 6615 (8251)	Winter Comfort Package hot-air heating Just Go 6815 EB, 6905 (8251)	Winter Comfort Package hot-air heating Just Go7055 (8251)
Insulated under-floor pipes	x	x	x
Switch for water pump	x	x	x
Gas hot-air heating 6kW with 1.8kW electric heating element and hot-water boiler incl. digital control panel	x	x	x
Waste water tank and pipes electrically heated	x	x	x
Insulated waste water tank	x	x	x
XPS insulation	x		
XPS insulation		x	
XPS insulation			x
Additional weight (kg)*	25	26	27

Pre-wiring kit (11350)	
Pre-wiring for solar	
Pre-wiring for roof A/C	
Pre-wiring for satellite system	
Pre-wiring for first reversing camera	
Pre-wiring for second reversing camera	
Additional weight (kg)*	7.6

△ Not known at the time of publication



The factory installation of optional equipment increases the actual mass of the vehicle and reduces the pay-mass. The additional weight indicated for packages and optional equipment shows the additional weight compared to the standard equipment of the respective model or layout. The total weight of the selected optional equipment must not exceed the manufacturer-specified mass for

optional equipment shown in the model overviews. This is a calculated value for each type and layout that Dethleffs uses to determine the maximum weight available for factory-fitted optional equipment. Detailed information and explanations on the subject of weight can be found in the Legal information section.

Optional equipment**

	Included in package	Additional weight (kg)*	Code	T 6615 EB	T 6815 EB	T 6905	T 7055 DBL	T 7055 EB	T 7055 EBL
Ford chassis									
Ford Transit Light low platform (3,499 kg), TDCi EcoBlue (2.0 l / 114 kW / 155 hp) Heavy Duty, 6-speed automatic transmission ⁵⁾	—	45	155A	○	○	○	○	○	○
Ford Transit Light low platform (3,499 kg), TDCi EcoBlue (2.0 l / 114 kW / 155 hp) Heavy Duty, 6-speed manual transmission	—	0	155S	○	○	○	○	○	○
Ford Transit Light low platform (3,499 kg), TDCi EcoBlue (2.0 l / 96 kW / 130 hp) Heavy Duty, 6-speed automatic transmission ⁵⁾	—	45	130A	○	○	○	○	○	○
Ford chassis features									
Additional seat ¹³⁾	—	14	435	—	○	○	—	—	—
Tow bar (check permissible gross towing weight for trailer operation) ⁵⁾	—	50	273	—	○	○	—	—	—
Tow bar (check permissible gross towing weight for trailer operation) ⁵⁾	—	48	273	○	—	—	—	—	—
Tow bar (check permissible gross towing weight for trailer operation) ⁵⁾	—	51	273	—	—	—	○	○	○
Exterior features									
Access locker door left	CO	8	331	—	○	—	○	○	○
Access locker door left	CO	6	331	○	—	—	—	—	—
Bike rack for 3 bikes (lowerable)	—	21.1	7482	○	○	○	○	○	○
Bike rack for 3 bikes (rear)	—	9.6	938	○	○	○	○	○	○
Stable, double-glazed flush-fitting windows with integrated blinds and flyscreens	—	1	415	○	○	○	○	○	○
Interior design									
Upholstery Calypso incl. driver and passenger seat cover ¹²⁾	—	0	13491	○	○	○	○	○	○
Furniture layouts									
Bed convert for seating lounge transverse	—	6.5	1944	—	○	○	—	—	—
Bed convert for seating lounge transverse	—	7.5	1944	—	—	—	—	○	—
Bed convert for seating lounge transverse	—	5.5	1944	—	—	—	○	—	○
Electric pull-down bed across the seating unit	—	72	680	—	—	—	○	—	○
Electric pull-down bed across the seating unit	—	65	680	—	—	—	—	○	—
Electric pull-down bed across the seating unit	—	64	680	—	—	○	—	—	—
Electric pull-down bed across the seating unit	—	62	680	—	○	—	—	—	—
Electric single folding bed above the seating group	—	52	680	○	—	—	—	—	—
ISOFIX child seat bracket for third and fourth seat facing direction of travel	—	4	8125	○	○	○	—	○	—
Makeshift bed	—	4.5	339	○	—	—	—	—	—
Option to convert single beds to double bed	CO	8	1883	○	○	—	—	○	○
Kitchen									
Fridge (137 l)	—	18	713	○	—	—	—	—	—
Fridge (137 l) with integrated oven	—	12	290	—	—	○	○	○	○
Bathroom									
Additional window in bathroom	—	5	372	—	—	—	○	○	○
Shower grid	—	2	1657	○	—	—	○	○	○
Shower grid	—	1.5	1657	—	○	—	—	—	—
Shower grid	—	4.5	1657	—	—	○	—	—	—
Multimedia									
Dethleffs Moniceiver incl. DAB+, Apple Carplay and Android Auto ^{15) 3)}	—	2.3	13222	○	○	○	○	○	○
Second reversing camera in rear moulding	—	1	11541	○	○	○	○	○	○



The factory installation of optional equipment increases the actual mass of the vehicle and reduces the pay-mass. The additional weight indicated for packages and optional equipment shows the additional weight compared to the standard equipment of the respective model or layout. The total weight of the selected optional equipment must not exceed the manufacturer-specified mass for optional equipment shown in the model overviews. This is a calculated value for each type and layout that Dethleffs uses to determine the maximum weight available for factory-fitted optional equipment. Detailed information and

explanations on the subject of weight can be found in the Legal information section. An increase of load capacity increases the manufacturer-specified mass for optional equipment. The increase results from the higher pay-mass due to the alternative chassis. The increased tare weight of the alternative chassis and, in particular, the weight for any mandatory heavier engine variants (e.g. 180 hp) must be deducted from this. For a more detailed description of all mandatory technical dependencies, please refer to the explanations on the footnotes.

Optional equipment**

	Included in package	Additional weight (kg)*	Code	T 6615 EB	T 6815 EB	T 6905	T 7055 DBL	T 7055 EB	T 7055 EBL
Heating									
Gas hot-air heating 6kW with 1.8kW electric heating element and hot-water boiler incl. digital control panel	WI-KO	1	330	○	○	○	○	○	○
Electrical installation									
Second leisure battery AGM, 95 Ah ¹¹⁾	—	27	830	○	○	○	○	○	○
Solar power system 100 watt	—	12.6	922	○	○	○	○	○	○
Water supply									
Insulated waste water tank	WI-KO	8.5	665	○	○	○	○	○	○
Switch for water pump	WI-KO	0.2	397	○	○	○	○	○	○
Gas supply									
Automatic gas cylinder switchover incl. crash sensor, EisEx and gas filter	—	2.5	1577	○	○	○	○	○	○
Packages									
Camper Premium Package	—	13	13715	○	○	○	○	○	○
Comfort Package T 6615 EB	—	51.65	13803	○	—	—	—	—	—
Comfort Package T 6815, 7055 EB	—	53.65	13803	—	○	—	—	○	—
Comfort Package T 6905	—	43.65	13803	—	—	○	—	—	—
Comfort Package T 7055 DBL	—	37.65	13803	—	—	—	○	—	—
Comfort Package T 7055 EBL	—	45.65	13803	—	—	—	—	—	○
Package One, 4 m awning	—	51.6	12126	○	○	○	—	—	—
Package One, 4,5 m awning	—	55.6	12126	—	—	—	○	○	○
Package X (awning 4.0 m)	—	35.1	11936	○	○	○	—	—	—
Package X (awning 4.5 m)	—	39.1	11936	—	—	—	○	○	○
Pre-wiring kit	—	7.6	11350	○	○	○	○	○	○
Winter Comfort Package hot-air heating Just Go 6615	—	25	8251	○	—	—	—	—	—
Winter Comfort Package hot-air heating Just Go 6815 EB, 6905	—	26	8251	—	○	○	—	—	—
Winter Comfort Package hot-air heating Just Go7055	—	27	8251	—	—	—	○	○	○
Miscellaneous									
Registration documents (CoC papers)	—	0	15152	◆	◆	◆	◆	◆	◆

○ Optional equipment — Not possible ● Standard equipment ◆ Mandatory △ Not known at the time of publication

CO Comfort Package WI-KO Winter Comfort Package



The factory installation of optional equipment increases the actual mass of the vehicle and reduces the pay-mass. The additional weight indicated for packages and optional equipment shows the additional weight compared to the standard equipment of the respective model or layout. The total weight of the selected optional equipment must not exceed the manufacturer-specified mass for optional equipment shown in the model overviews. This is a calculated value for each type and layout that Dethleffs uses to determine the maximum weight available for factory-fitted optional equipment. Detailed information and

explanations on the subject of weight can be found in the Legal information section. An increase of load capacity increases the manufacturer-specified mass for optional equipment. The increase results from the higher pay-mass due to the alternative chassis. The increased tare weight of the alternative chassis and, in particular, the weight for any mandatory heavier engine variants (e.g. 180 hp) must be deducted from this. For a more detailed description of all mandatory technical dependencies, please refer to the explanations on the footnotes.

IMPORTANT INFORMATION FOR THE SELECTION OF YOUR MOTORHOMES

When buying a motorhome, camper van or urban vehicle (hereafter: motorhome), it is particularly important to choose the right layout and an appealing design. In addition, weight also plays an essential role. Family, friends, optional equipment, accessories and baggage – space must be available for all of these. At the same time, there are legal and technical limits to the configuration and load. Every motorhome is designed for a certain weight, which may not be exceeded during driving. For motorhome buyers, this raises the question: How should I configure my vehicle to accommodate passengers, baggage and accessories according to my needs without the vehicle exceeding this maximum weight? In order to make this decision easier for you, we provide you below with a few tips that are particularly important when selecting your vehicle from our portfolio:

1. The technically permissible maximum laden mass...

... is a value set by the manufacturer which the vehicle may not exceed. Dethleffs specifies a layout-related upper limit for the vehicle, which can vary from layout to layout (e.g. 3,500 kg, 4,400 kg). You can find the corresponding specification for each layout in the technical data.

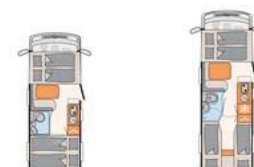

Low Profile model overview

		Model 1	Model 2
Standard chassis		Fiat Ducato	Fiat Ducato
Emission standards		Euro 6d Final	Euro 6d Final
Overall length, approx.	cm	599	695
Overall width, approx.	cm	220	220
Overall height, approx.	cm	281	281
technically permissible maximum laden mass	kg	3499	3499
Mass in running order	kg	2.890 (2.746 - 3.035)*	2.982 (2.833 - 3.131)*
Permitted number of seats (including driver)		4	4
Manufacturer-specified mass for optional equipment	kg	245	149

2. The mass in running order...

... consists – to put it simply – of the basic vehicle with standard equipment plus a standard weight of 75 kg for the driver. It is legally permissible and possible for the mass in running order of your vehicle to deviate from the nominal value stated in the sales documents. The permissible tolerance is $\pm 5\%$. The permissible range in kilograms is given in brackets after the mass in running order. In order to provide you with full transparency regarding possible weight deviations, Dethleffs weighs each vehicle at the end of the line and informs your trade partner of your vehicle's weighing result for forwarding to you. Detailed explanations on the subject of mass in running order can be found in the "Legal Information" section.

3. The permitted number of seats (including driver)...

...is determined by the manufacturer in what is referred to as the type-approval procedure. This results in what is referred to as the mass of the passengers. For this, a standard weight of 75 kg per passenger (without driver) is calculated. Detailed explanations on the subject of mass of the passengers can be found in the "Legal Information" section



Low Profile model overview

		Model 1	Model 2
Standard chassis		Fiat Ducato	Fiat Ducato
Emission standards		Euro 6d Final	Euro 6d Final
Overall length, approx.	cm	599	695
Overall width, approx.	cm	220	220
Overall height, approx.	cm	281	281
technically permissible maximum laden mass	kg	3499	3499
Mass in running order	kg	2.890 (2.746 - 3.035)*	2.982 (2.833 - 3.131)*
● Permitted number of seats (including driver)		4	4
● Manufacturer-specified mass for optional equipment	kg	245	149

4. The manufacturer-specified mass for optional equipment...

... is a value set by Dethleffs per layout for the maximum mass of optional equipment that can be ordered. This limit is intended to ensure that the minimum pay-mass, i.e. the legally prescribed free mass for baggage and retrofitted accessories, is actually available for the vehicle load capacity of the vehicles delivered by Dethleffs. If, in exceptional cases, the weighing at the end of the line nevertheless shows that the actual load capacity falls short of the minimum pay-mass due to a permissible weight deviation, we will check together with your trade partner and you whether we should, for example, increase the load capacity of the vehicle, reduce the number of seats or remove optional equipment before delivering the vehicle. Detailed explanations on the subject of the effects of the tolerances on the minimum pay-mass and the payload can be found in the "Legal Information" section.

Optional extra

		Price €	Additional weight	Code	Model 1	Model 2
Bathroom						
Shower grid	—	359,-	9	1385	—	○
Additional window in bathroom	—	269,-	5	9845	○	○
Multimedia						
Automatic HD satellite system 65 Twin	—	549,-	15	713	○	—
Dethleffs Naviceiver incl. DAB+, truck navigation and connection to on-board control panel		238,-	1.5	1657	○	●

5. The additional weight of optional equipment and packages...

... increases the actual mass of the vehicle (= mass in running order plus selected optional equipment) and reduces the pay-mass. The specified value shows the additional weight compared to the standard equipment of the respective layout. The total weight of the selected packages and optional equipment must not exceed the manufacturer-specified mass for optional equipment."